

安溪县人民政府文件

安征预〔2023〕30号

安溪县人民政府关于安溪县尚卿乡科名村 中部 SQ-B-01 地块征收（使用） 土地预公告

为实施安溪县国民经济和社会发展规划、国土空间规划，根据《中华人民共和国土地管理法》等法律法规的规定，现发布安溪县尚卿乡科名村中部 SQ-B-01 地块项目征收（使用）土地预公告：

一、征收（使用）土地的范围、目的

1. 拟用地面积：1.7853 公顷。

2. 用地范围：东至路兴、永全厝

西至科名村八选角落路

南至 339 县道

北至科名村八选角落桥

具体位置详见规划选址红线图。

3. 涉及的村集体经济组织（具体以土地现状调查结果为准）尚卿乡科名村。

4. 用地目的：本次征收（使用）土地用于安溪县尚卿乡科名村中部 SQ-B-01 地块项目建设，为政府组织实施的成片开发建设，属于公共利益需要，符合《中华人民共和国土地管理法》第四十五条规定。

二、其他事项

拟于 2023 年 9 月 19 日至 2023 年 10 月 9 日由尚卿乡政府组织有关部门进行土地现状调查，有关单位和个人应予积极支持配合。

本公告发布之日起，凡在拟征收（使用）土地范围内抢栽、抢种、抢建等，一律不予补偿。

本公告在征收（使用）土地涉及的乡镇和村集体经济组织所在地予以张贴，公告时间为十个工作日，村集体经济组织应及时将本公告内容通知被用地的单位和个人。

本次征收（使用）土地的实施单位为尚卿乡政府，由尚卿乡代表我县人民政府签订补偿安置协议等土地征收（使用）法定程序。

特此公告。

附件：规划选址红线图



科名村中部SQ-B-01地块勘界图

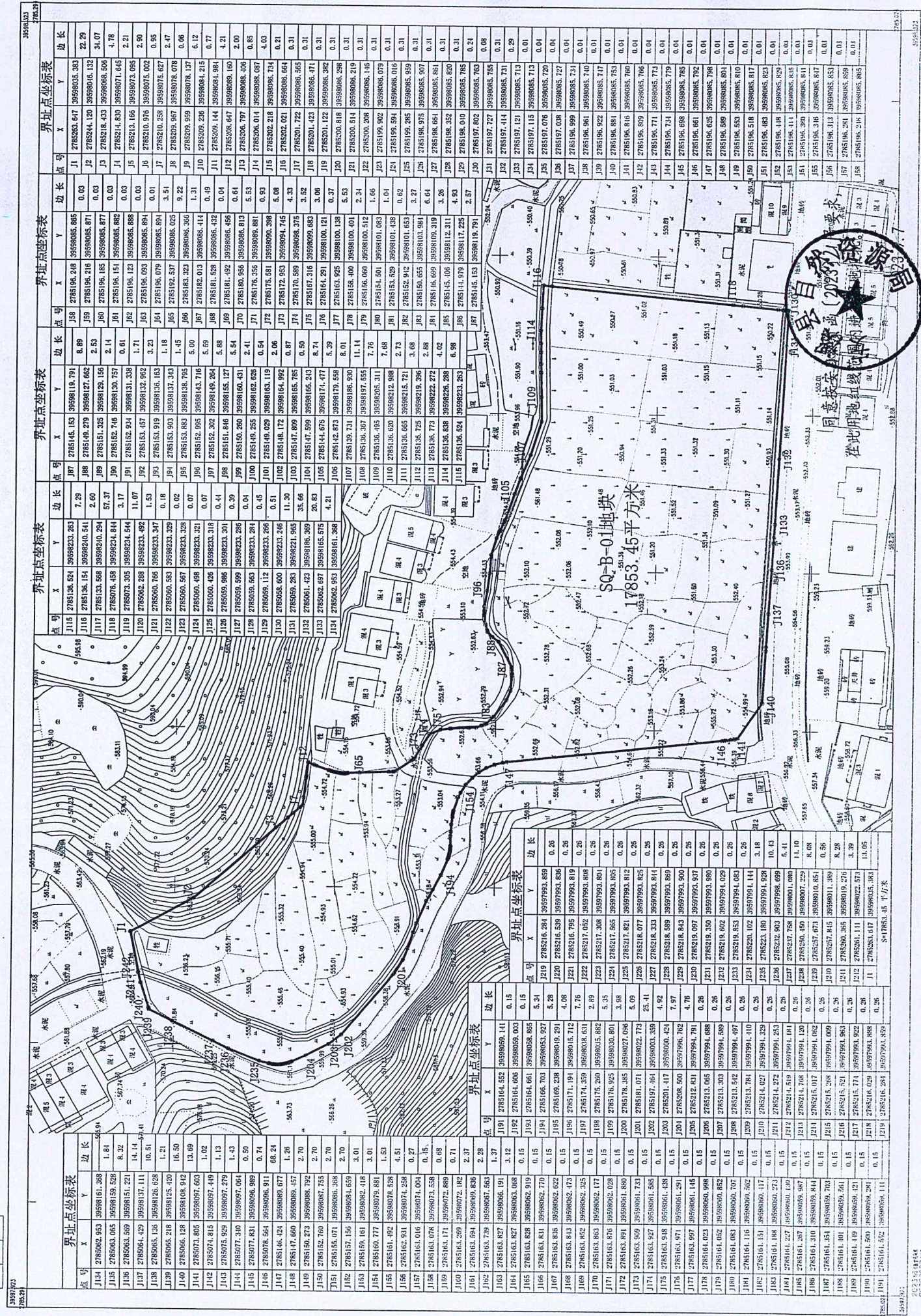

界址点坐标表			界址点坐标表			界址点坐标表			界址点坐标表		
点号	X	Y	点号	X	Y	点号	X	Y	点号	X	Y
J134	2785062.953	3959811.368	J135	2785063.065	3959815.528	J136	2785063.589	3959815.221	J137	2785064.429	3959813.111
J138	2785065.126	3959812.628	J139	2785066.218	3959812.420	J140	2785067.128	3959810.942	J141	2785072.805	3959807.600
J142	2785074.815	3959807.419	J143	2785075.929	3959807.279	J144	2785077.310	3959807.054	J145	2785077.831	3959806.989
J148	2785078.561	3959806.911	J149	2785079.675	3959806.792	J150	2785081.760	3959807.735	J151	2785082.874	3959808.678
J155	2785092.931	3959807.258	J156	2785094.045	3959807.141	J157	2785095.159	3959806.924	J158	2785096.273	3959806.807
J162	2785101.349	3959807.588	J163	2785102.463	3959807.471	J164	2785103.577	3959807.354	J165	2785104.691	3959807.237
J170	2785113.835	3959808.622	J171	2785114.949	3959808.505	J172	2785116.063	3959808.388	J173	2785117.177	3959808.271
J177	2785124.321	3959809.307	J178	2785125.435	3959809.190	J179	2785126.549	3959809.073	J180	2785127.663	3959808.956
J187	2785131.151	3959809.702	J188	2785132.265	3959809.585	J189	2785133.379	3959809.468	J190	2785134.493	3959809.351
J198	2785141.001	3959809.594	J199	2785142.115	3959809.477	J200	2785143.229	3959809.360	J201	2785144.343	3959809.243
J208	2785151.851	3959809.139	J209	2785152.965	3959809.022	J210	2785154.079	3959808.905	J211	2785155.193	3959808.788
J216	2785161.701	3959808.683	J217	2785162.815	3959808.566	J218	2785163.929	3959808.449	J219	2785165.043	3959808.332
J226	2785171.551	3959807.927	J227	2785172.665	3959807.810	J228	2785173.779	3959807.693	J229	2785174.893	3959807.576
J236	2785181.401	3959807.170	J237	2785182.515	3959807.053	J238	2785183.629	3959806.936	J239	2785184.743	3959806.819
J246	2785191.251	3959806.413	J247	2785192.365	3959806.296	J248	2785193.479	3959806.179	J249	2785194.593	3959806.062
J256	2785201.101	3959805.655	J257	2785202.215	3959805.538	J258	2785203.329	3959805.421	J259	2785204.443	3959805.304
J266	2785210.951	3959804.897	J267	2785212.065	3959804.780	J268	2785213.179	3959804.663	J269	2785214.293	3959804.546
J276	2785220.801	3959803.939	J277	2785221.915	3959803.822	J278	2785223.029	3959803.705	J279	2785224.143	3959803.588
J286	2785230.651	3959802.981	J287	2785231.765	3959802.864	J288	2785232.879	3959802.747	J289	2785233.993	3959802.630
J296	2785240.501	3959802.023	J297	2785241.615	3959801.906	J298	2785242.729	3959801.789	J299	2785243.843	3959801.672
J306	2785250.351	3959801.065	J307	2785251.465	3959800.948	J308	2785252.579	3959800.831	J309	2785253.693	3959800.714
J316	2785260.201	3959800.107	J317	2785261.315	3959799.989	J318	2785262.429	3959799.872	J319	2785263.543	3959799.755
J326	2785270.051	3959799.249	J327	2785271.165	3959799.132	J328	2785272.279	3959799.015	J329	2785273.393	3959788.898
J336	2785280.901	3959798.291	J337	2785282.015	3959798.174	J338	2785283.129	3959798.057	J339	2785284.243	3959797.940
J346	2785290.751	3959797.333	J347	2785291.865	3959797.216	J348	2785292.979	3959797.099	J349	2785294.093	3959796.982
J356	2785300.601	3959796.375	J357	2785301.715	3959796.258	J358	2785302.829	3959796.141	J359	2785303.943	3959796.024
J366	2785310.451	3959795.417	J367	2785311.565	3959795.300	J368	2785312.679	3959795.183	J369	2785313.793	3959795.066
J376	2785320.301	3959794.459	J377	2785321.415	3959794.342	J378	2785322.529	3959794.225	J379	2785323.643	3959794.108
J386	2785330.151	3959793.501	J387	2785331.265	3959793.384	J388	2785332.379	3959793.267	J389	2785333.493	3959793.150
J396	2785340.001	3959792.543	J397	2785341.115	3959792.426	J398	2785342.229	3959792.309	J399	2785343.343	3959792.192
J406	2785349.851	3959791.585	J407	2785350.965	3959791.468	J408	2785352.079	3959791.351	J409	2785353.193	3959791.234
J416	2785359.701	3959790.627	J417	2785360.815	3959790.510	J418	2785361.929	3959790.393	J419	2785363.043	3959790.276
J426	2785369.551	3959790.069	J427	2785370.665	3959790.151	J428	2785371.779	3959790.034	J429	2785372.893	3959789.917
J436	2785379.401	3959789.111	J437	2785380.515	3959789.024	J438	2785381.629	3959788.907	J439	2785382.743	3959788.790
J446	2785389.251	3959788.153	J447	2785390.365	3959788.036	J448	2785391.479	3959779.919	J449	2785392.593	3959779.802
J456	2785399.101	3959787.195	J457	2785400.215	3959787.078	J458	2785401.329	3959769.961	J459	2785402.443	3959769.844
J466	2785408.951	3959786.237	J467	2785410.065	3959786.120	J468	2785411.179	3959786.003	J469	2785412.293	3959777.886
J476	2785418.801	3959785.279	J477	2785419.915	3959785.162	J478	2785421.029	3959785.045	J479	2785422.143	3959779.928
J486	2785428.651	3959784.321	J487	2785429.765	3959784.204	J488	2785430.879	3959784.087	J489	2785431.993	3959783.970
J496	2785438.501	3959783.363	J497	2785439.615	3959783.246	J498	2785440.729	3959783.129	J499	2785441.843	3959783.012
J506	2785448.351	3959782.405	J507	2785449.465	3959782.288	J508	2785450.579	3959782.171	J509	2785451.693	3959782.054
J516	2785458.201	3959781.447	J517	2785459.315	3959781.330	J518	2785460.429	3959781.213	J519	2785461.543	3959781.096
J526	2785468.051	3959780.489	J527	2785469.165	3959780.372	J528	2785470.279	3959780.255	J529	2785471.393	3959780.138
J536	2785477.901	3959779.531	J537	2785479.015	3959779.414	J538	2785480.129	3959779.297	J539	2785481.243	3959779.180
J546	2785487.751	3959778.573	J547	2785488.865	3959778.456	J548	2785489.979	3959778.339	J549	2785491.093	3959778.222
J556	2785497.601	3959777.615	J557	2785498.715	3959777.498	J558	2785499.829	3959777.381	J559	2785500.943	3959777.264
J566	2785507.451	3959776.657	J567	2785508.565	3959776.540	J568	2785509.679	3959776.423	J569	2785510.793	3959776.306
J576	2785517.301	3959775.699	J577	2785518.415	3959775.582	J578	2785519.529	3959775.465	J579	2785520.643	3959775.348
J586	2785527.151	3959774.741	J587	2785528.265	3959774.624	J588	2785529.379	3959774.507	J589	2785530.493	3959774.390
J596	2785537.001	3959773.783	J597	2785538.115	3959773.666	J598	2785539.229	3959773.549	J599	2785540.343	3959773.432
J606	2785546.851	3959772.825	J607	2785547.965	3959772.708	J608	2785549.079	3959772.591	J609	2785550.193	3959772.474
J616	2785556.701	3959771.867	J617	2785557.815	3959771.750	J618	2785558.929	3959771.633	J619	2785560.043	3959771.516
J626	2785566.551	3959770.909	J627	2785567.665	3959770.792	J628	2785568.779	3959770.675	J629	2785569.893	3959770.558
J636	2785576.401	3959770.051	J637	2785577.515	3959769.934	J638	2785578.629	3959769.817	J639	2785579.743	3959769.700
J646	2785586.251	3959769.093	J647	2785587.365	3959768.976	J648	2785588.479	3959768.859	J649	2785589.593	3959768.742
J656	2785596.101	3959768.135	J657	2785597.215	3959768.058	J658	2785598.329	3959767.941	J659	2785599.443	3959767.824
J666	2785605.951	3959767.177	J667	2785607.065	3959767.060	J668	2785608.179	3959766.943	J669	2785609.293	3959766.826
J676	2785615.801	3959766.219	J677	2785616.915	3959766.102	J678	2785618.029	3959765.985	J679	2785619.143	3959765.868
J686	2785625.651	3959765.261	J687	2785626.765	3959765.144	J688	2785627.879	3959765.027	J689	2785628.993	3959749.910
J696	2785635.501	3959764.303	J697	2785636.615	3959764.186	J698	2785637.729	3959764.069	J699	2785638.843	3959763.952
J706	2785645.351	3959763.345	J707	2785646.465	3959763.228	J708	2785647.579	3959763.111	J709	2785648.693	3959762.994
J716	2785655.201	3959762.387	J717	2785656.315	3959762.270	J718	2785657.429	3959762.153	J719	2785658.543	3959762.036
J726	2785665.051	3959761.429	J727	2785666.165	3959761.312	J728	2785667.279	3959761.195	J729	2785668.393	3959761.078
J736	2785674.901	3959760.471	J737	2785676.015	3959760.354	J738	2785677.129	3959760.237	J739	2785678.243	3959760.120
J746	2785684.751	3959759.513	J747	2785685.865	3959759.396	J748	2785686.979	3959759.279	J749	2785688.093	3959759.162
J756	2785694.601	3959758.555	J757	2785695.715	3959758.438	J758	2785696.829	3959758.321	J759	2785697.943	3959758.204
J766	2785704.451	3959757.597	J767	2785705.565	3959757.420	J768</					